

# ATELIER PURCELL

## PADUS HOST DINING CHAIR

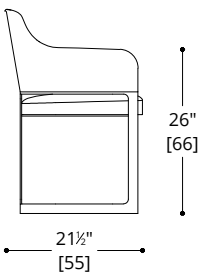
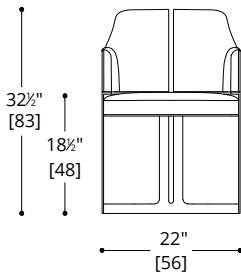
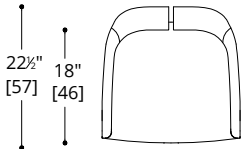

# ATELIER PURCELL

---

## PADUS HOST DINING CHAIR

### LEGS

Standard Metal: Bronze (SMB30), Dark Bronze (SMDB31), Obsidian (SMO34), Brushed Brass (SMBB33), Brushed Stainless Steel (SMBS35),

COM Required: 3.7 m [4 yd]

COL Required: 6.7 m<sup>2</sup> [72 ft<sup>2</sup>]

ROLLING STOCK FRAME OPTIONS:  
DARK BRONZE (SMDB31).  
ALL OTHER STANDARD METAL  
FINISHES MINIMUM ORDER  
QUANTITY: 4 - LEAD TIME 14-18  
WEEKS.



---

### NOTES:

PLEASE CONFIRM DETAILS OF THIS TEAR SHEET WITH YOUR LOCAL SALES ASSOCIATE.

---

Purcell Design reserves the right to make technological and aesthetic improvements to its models, including changes to the sizes and materials, without notice. The technical drawings do not define the details of the product. The measurements shown are indicative and may undergo changes. In particular, the dimensions relevant to the padded parts are subject to usage tolerances over time caused by the normal adjustment of the padding. For specific information, please contact us directly or the dealer closest to you.